

SQUARE FOOTAGE	
±S.F.	
5,576	TOTAL
2,851	FRONT OF HOUSE 43%
2,725	BACK OF HOUSE 57%
21.28	SEATING RATIO
2,067	PATIO

SEATING ANALYSIS	
COUNT	
13	BAR TOP SEATING
18	BAR SEATING
57	DINING ROOM
20	BOOTH SEATING
11	PRIVATE DINING
8	EDUCATIONAL ROOM
80	EXTERIOR DINING AREA
127	TOTAL (EXCLUDING EXTERIOR)
207	TOTAL

Healthy America
8900 W. Venice Blvd., #101
Los Angeles, CA 90232

Legal Description
Lot: FR Lots 1 & 18, Lots 19 & 52
Block: None
Tract: TR 5461
APN: 4312-014-093

Lot Area: 42,882 sf (in Los Angeles)
On-Site Parking: 1,538 shared spaces

ISSUE DATE

△ PRELIM PLAN 03-11-22

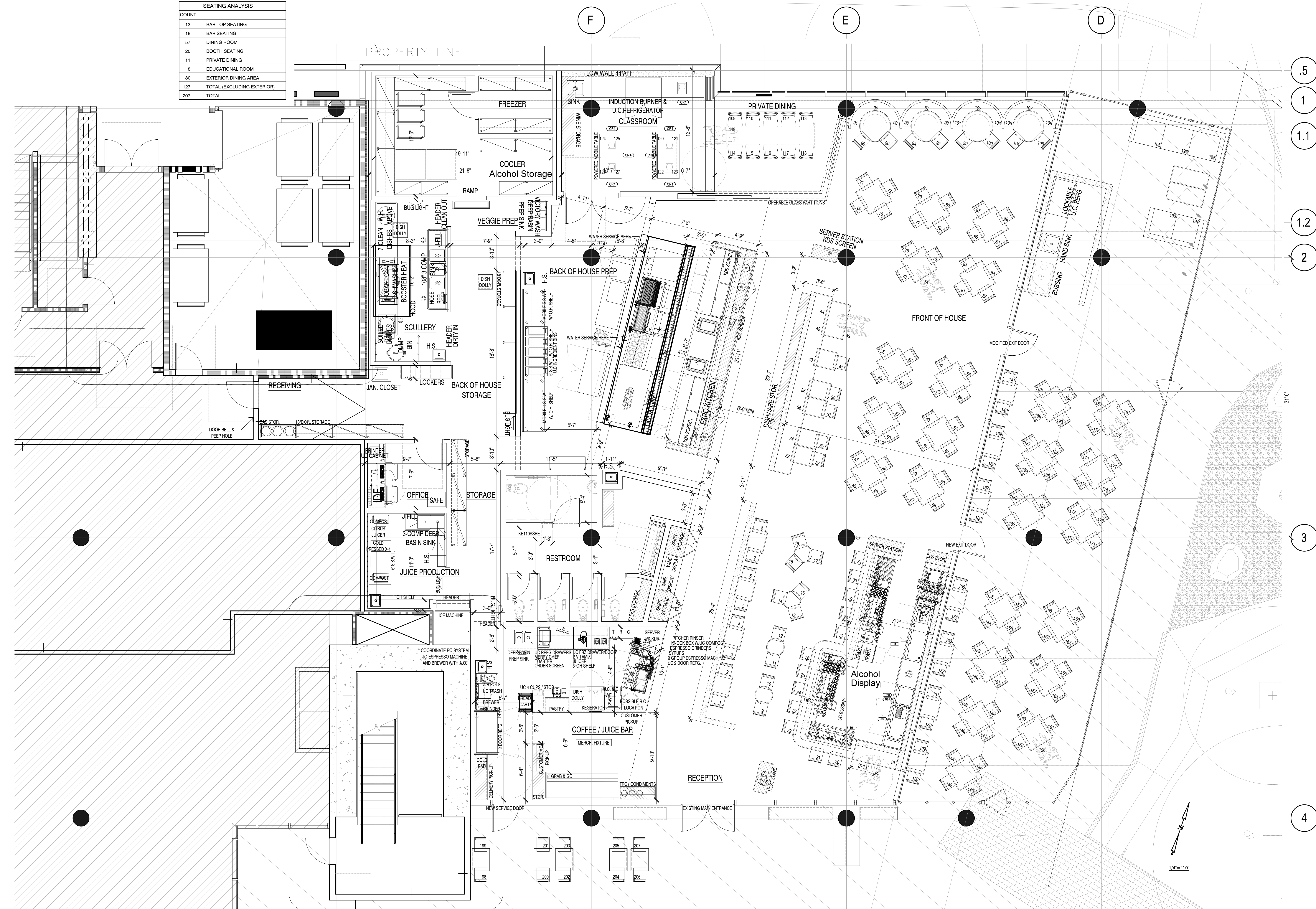

HEALTHY AMERICA
Ivy Station | 8900 Venice Blvd.
Suite 101
Los Angeles, CA 90232

PRELIMINARY FLOOR PLAN

F-1